

Item number: **FRS.06.112.80201/B**Revision: **00** • Date: **08 - 2024****Mounting kit for EVO footrest** ~ 0.5 h.EASY      DIFFICULT

ENGLISH Thank you for choosing this premium product from SW-MOTECH. Visit our online shop for more information (e.g. model assignments). Required documents (e.g. national type approval) are available there for you to download.

Please read and understand all the instructions, safety information and warnings in these mounting instructions before mounting and using the product in order to avoid injury and damage. Keep these mounting instructions for reference.

This product was developed for vehicles in factory condition. Compatibility with original accessories or accessories from other manufacturers cannot be guaranteed.

These mounting instructions have been prepared to the best of our current knowledge. No legal claims relating to accuracy can be made. Errors and omissions excepted. We reserve the right to make technical and design changes. The copyright is held by SW-MOTECH.

SAFETY WARNING SYMBOL

 This warning symbol is used in these mounting instructions to warn of deadly dangers, injuries or other hazards. The words **DANGER**, **WARNING** or **CAUTION** are used as part of this warning symbol to convey important safety messages and information relating to the installation and use of this product. These words, together with the safety warning symbol, mean:

 **DANGER:** Indicates a hazardous situation which, if not avoided, will result in death or serious injury!

 **WARNING:** Indicates a hazardous situation which, if not avoided, may result in death or serious injury!

 **CAUTION:** Indicates a hazardous situation which, if not avoided, may result in minor or moderate injury!

 **NOTE:** Important information, but not relating to a risk of death or injury (property damage only)!

GENERAL INFORMATION

 **WARNING:** Assembly and/or maintenance of this product requires advanced technical skill, appropriate tools, and a good understanding of tool usage and torque specifications. For your own safety, SW-MOTECH recommends having the assembly and/or maintenance carried out by a qualified and certified motorcycle workshop.

 **WARNING:** If you do choose to assemble this product yourself, carefully and fully read the mounting instructions before assembly and use, and follow all instructions to avoid serious injury or death. Also observe all relevant information in the vehicle manual when mounting or using the product. IF YOU DO NOT UNDERSTAND ANY PART OF THESE MOUNTING INSTRUCTIONS OR NEED AN EXPLANATION AS TO A SPECIFIC INSTRUCTION, DO NOT ATTEMPT TO INSTALL THIS PRODUCT WITHOUT CONSULTING SW-MOTECH FOR ASSISTANCE!

PREPARATION: Read the mounting instructions carefully and make sure that all parts on the parts list are available.

 **CAUTION:** Ensure that your vehicle is standing securely. Switch off the engine and remove the ignition key. Allow the engine/exhaust to cool down if necessary. Disconnect the battery when working on the electrical system. Only use proper tools and always wear safety goggles and gloves during assembly and maintenance. Have a second person help you with assembly and maintenance.

ASSEMBLY: All parts and connections removed from the vehicle must be reinstalled according to the vehicle manufacturer's specifications or replaced with parts and hardware supplied by SW-MOTECH.

 **WARNING:** Secure all threads with a medium-strength liquid threadlocker, unless otherwise specified.

 **DANGER:** Tightening torques not defined by SW-MOTECH must be obtained from the vehicle manufacturer or a certified motorbike workshop.



FUNCTIONAL CHECK: After mounting the product, ensure that no moving parts are obstructed and that the function of the vehicle is not impeded. Cables and hoses must not rub against each other and/or be hindered in any way.

 **WARNING:** Carry out a comprehensive functionality check before you start to drive. Check the tightening torque of all connections and the tight fit of the product after the first 50 km and then at regular intervals. Mounted accessories can change the handling and stability of the vehicle.



SW-MOTECH GmbH & Co. KG
Ernteweg 7-10
35282 Rauschenberg
Germany

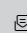

 info@sw-motech.com
 www.sw-motech.com



Take note of the symbols and what they mean in the ASSEMBLY section. If the term OEM appears in the ASSEMBLY section, the vehicle manufacturer's specifications must be observed and applied.



If you have any questions, please don't hesitate to contact our Customer Service team or our distributors. You can find our telephone number and a list of our distributors in our online shop:

www.sw-motech.com



Use thread locker: Indicates that a thread must be coated with liquid thread locker. H (HIGH): high strength; M (MEDIUM): medium strength; L (LOW): low strength.



Tighten/note the tightening torque information:

Indicates the tightening torque of a part specified by SW-MOTECH or the vehicle manufacturer (OEM).

2

1



FRS.56.112.Z15L.25

1/1

2



FRS.56.112.Z15R.25

1/1

5

3



M8 x 35; DIN 912
SC.ST.08.035.01.912.109

2/2

4



M6 x 35; DIN 913
GEW.00.06.035.01.913

2/2

5



Ø 10 / ø 6,2 / h 20
DB.ST.100.062.020.01

2/2

6



M6; DIN 1587
MU.ST.06.01.1587.06

2/2

7



KEK.00.M6.ISK

2/2

1



1.1

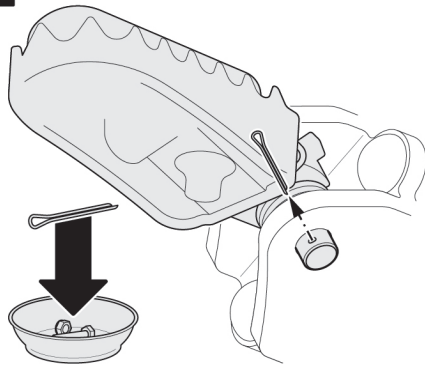

1.2

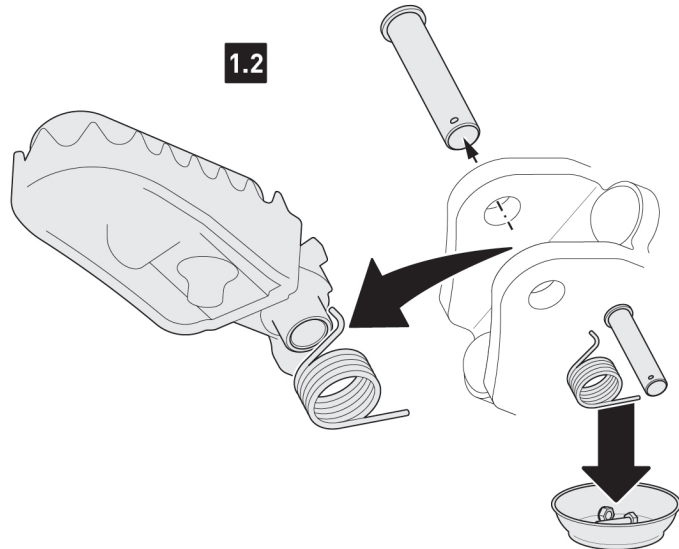

⚠ WARNING: Always wear eye and hand protection!
⚠ WARNING: Always use the proper tools!

⚠ NOTE: Assembly is shown on the left side. Repeat the assembly on the right side of the vehicle.

⚠ NOTE: Before removing the original footrest, note the order and orientation of the original attachments.

Step [1.1]: Remove the original cotter pins on both sides.

Step [1.2]: Dismantle the original footrests.



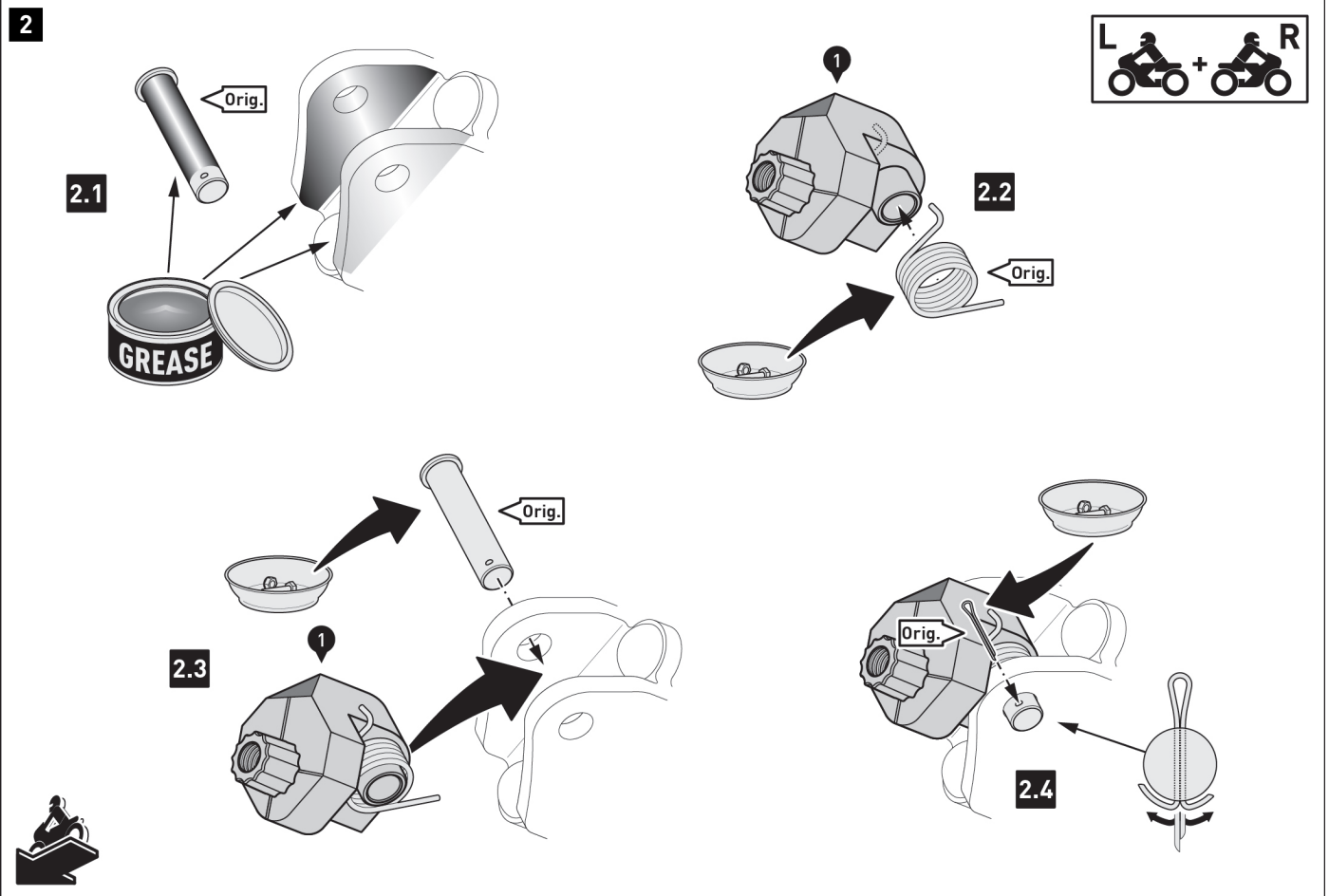

Step [2.1] : Clean the footrest mounts thoroughly. Apply some grease to the inside of the footrest mounts and the original bolts (Orig.).

Step [2.2] - [2.4]: Attach the joint adapters (1/2) to the footrest mounts using the original parts shown (Orig.).

⚠ WARNING: The bevelled surfaces of the joint adapters (1/2) must point upwards.

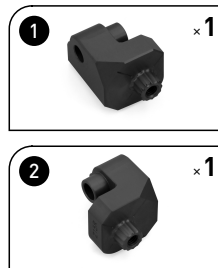

3

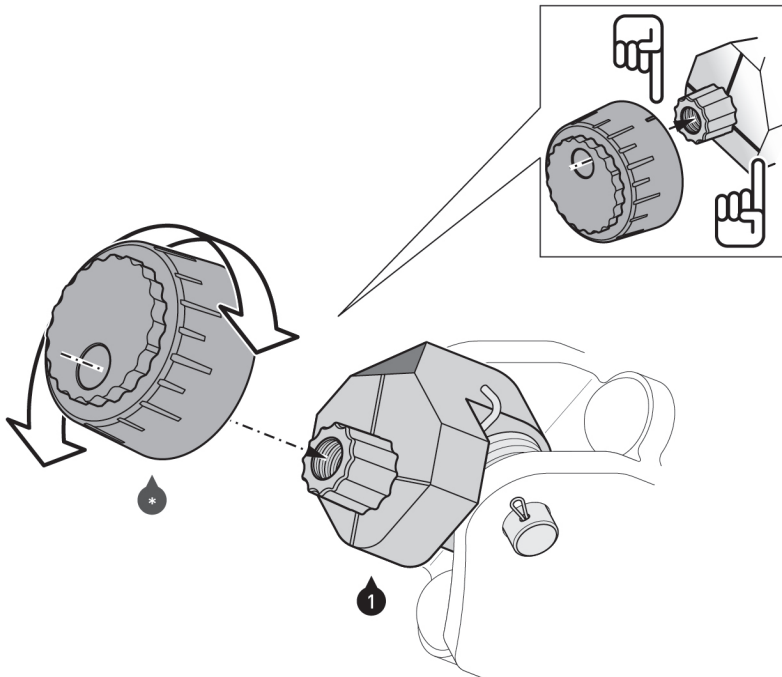

Original Position Original position	Tiefste Position Lowest position
 0 mm	 -15 mm
 -7,5 mm	
Nach vorne / forward	Nach hinten / backward

NOTE: The parts marked with a [*] are included with the EVO footrests (FRS.00.112.1000*/[*]).

Insert the positioning cones (*) onto the star-shaped receptacle cones of the joint adapters (1/2).
Because of the different mounting positions, the height of the footrests (*) can be individually adjusted (see detailed drawing on the right).

WARNING: Make sure to align the positioning cones (*) side-synchronously.

The markings on the joint adapters (1/2) and the positioning cones (*) serve as orientation (see left detailed drawing).

4

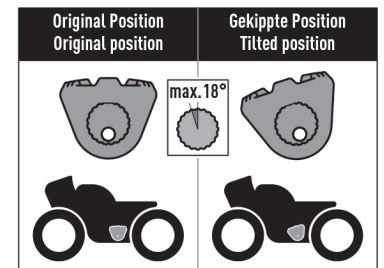
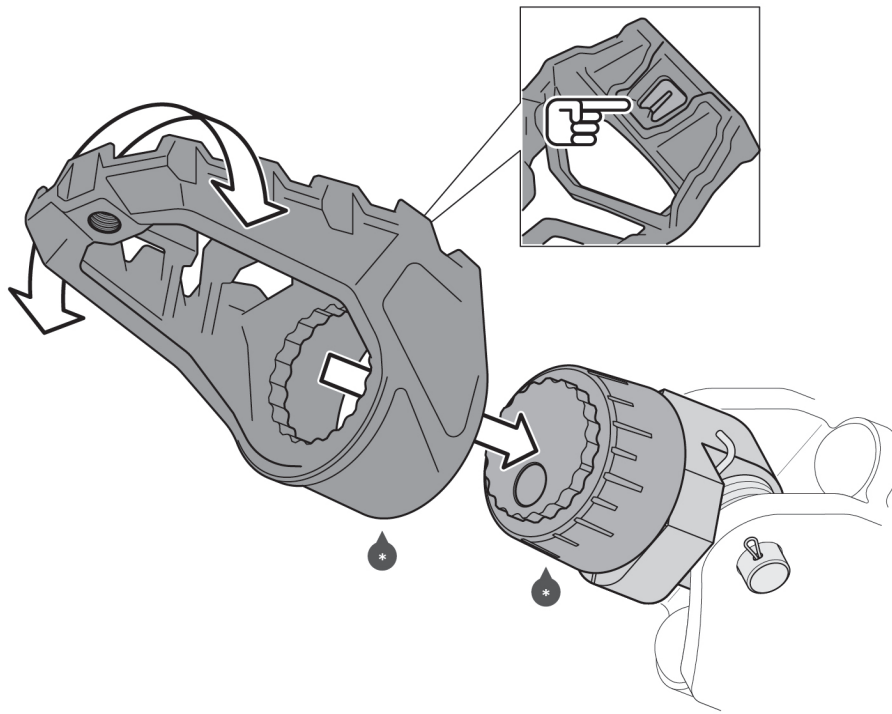

⚠ NOTE: The parts marked with a [*] are included with the EVO footrests (FRS.00.112.1000*/[*]).

Attach the footrests [*] to the positioning cones [*].
By interlocking the positioning cones [*], the angle of inclination of the footrests [*] can be individually adjusted (no more than 18°; see detailed drawing on the right).

⚠ WARNING: Make sure to align the footrests [*] side-synchronously.
The markings on the positioning cones [*] serve as orientation (see detailed drawing on the left).

5

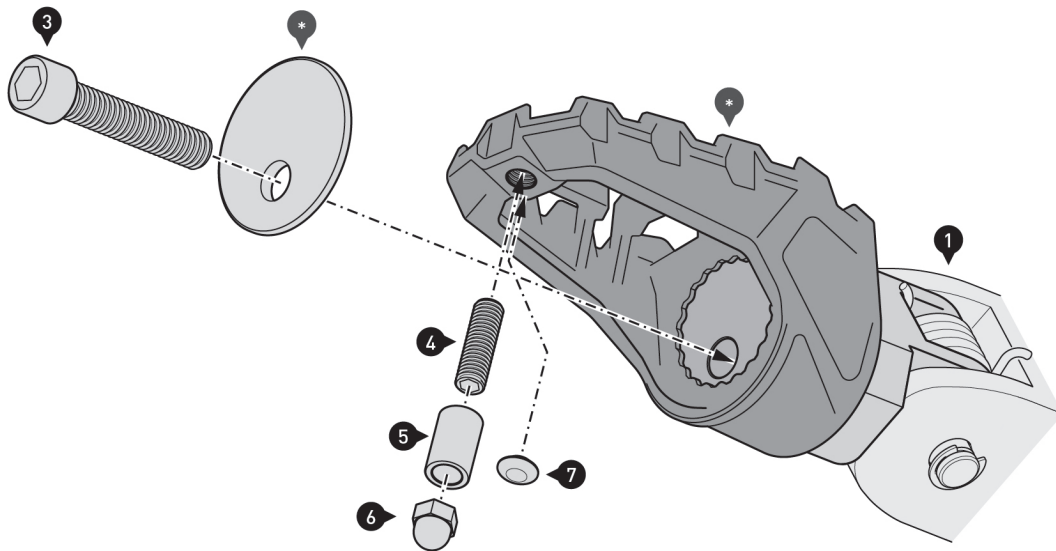

⚠ NOTE: The parts marked with a [*] are included with the EVO footrests (FRS.00.112.1000*/[*]).

First screw the EVO footrest (*) LOOSELY to the joint adapter (1/2).
Check again for side-synchronous alignment and ergonomics.

Then screw the EVO footrest (*) to the joint adapter (1/2).

⚠ WARNING: Use a liquid threadlocker!
Tighten the screw (3) as specified in the mounting instructions.

⚠ NOTE: Use parts (4) to (6) if your vehicle has the OEM lowering kit installed.
Otherwise, insert the plastic cap (7) into the opening of the EVO footrest (*).

Screw the threaded rod (4) onto the EVO footrest (*).

⚠ WARNING: Use liquid screw lock.
Tighten the grub screw (4) as described in the mounting instructions.

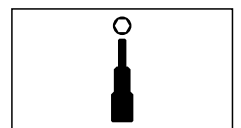
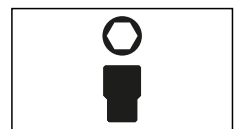
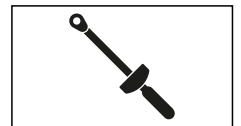
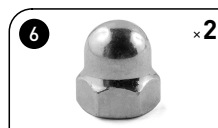
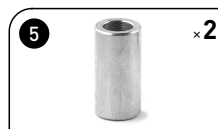
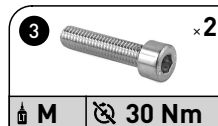

PRODUCT-SPECIFIC NOTES

⚠ WARNING: This product may inhibit cornering and ground clearance in cases of extreme inclination!

⚠ NOTE: Observe the country-specific regulations for the registration/operation of your vehicle or any applicable TÜV regulations. Have parts subject to registration entered in the vehicle documents by your inspection authority after installation.

If a national type approval is available for this product:

You must always carry the national type approval supplied with the product with you! This national type approval only applies to the models listed and must comply with all requirements! For use with a vehicle not listed here, the entry must be made in the vehicle documents!

The vehicle assignments in the national type approval document are expanded annually. As a result, the national type approval for a new product may only take place a few months after the market launch. If your model is not listed or if you no longer have the national type approval document, please visit the Download section of our web shop. The current version of the national type approval document will be available there.