

ACCESSORY

USB WEATHERPROOF WIRELESS CHARGING HEAD



SKU CODE	QLA-MOT-WCH-3
BARCODE (EAN-13)	9348943017565
MSRP	US \$74.99 AU \$109.95 CA \$109.99 EU €79.99 UK £69.99
MANUFACTURED IN	China
HS CODE	392690
HTS CODE (USA)	3926.90.9985
PRIMARY APPLICATIONS	Motorcycle

PRODUCT DETAILS

FEATURES	<p>DUAL STAGE SECURE POSITIVE LOCKING HEAD ON / OFF BUTTON TO POWER THE DEVICE ALUMINIUM REAR HOUSING WITH FINS FOR THERMAL MANAGEMENT IP66 WATER RESISTANT LED PROVIDES STATUS INDICATION CONNECT TO USB-A PORT ON MOTORCYCLE, OR WIRE TO SAE / BATTERY TERMINAL WITH OPTIONAL QUAD LOCK 12V TO USB SMART ADAPTOR</p>
INPUT	USB-C 5V/2A, 9V/2A, 12V/1.5A
OUTPUT	5W / 7.5W / 10W
COMPATIBLE WITH	<p>QUAD LOCK WATERPROOF 12V TO USB SMART ADAPTOR ALL QUAD LOCK 360 COMPATIBLE PRODUCTS QUAD LOCK MOTORCYCLE MOUNTS QUAD LOCK PHONE CASES</p>
WIRELESS CHARGING CAPABILITIES	<ul style="list-style-type: none"> • iPhone SE (3rd Gen), 14, 14 Plus, 14 Pro, 14 Pro Max, 13 Pro, 13 Pro Max, 13, 13 mini, 12 Pro, 12 Pro Max, 12, 12 mini, 11 Pro, 11 Pro Max, 11, SE (2nd Gen), X/Xs, Xs Max, XR, 8 Plus, 8 • Samsung Galaxy S23 Ultra, S23+, S23, S22 Ultra, S22+, S22, S21 FE, S21 Ultra, S21+, S21, Note20 Ultra, Note20, S20 FE, S20 Ultra, S20+, S20, Note10, Note10+, Note9, S10+, S10, S10e, S9+, S9, S8+ and S8 • Google Pixel 7 Pro, 7, 6 Pro, 6, 5, 4, 4 XL, 3, 3 XL • Huawei P40 Pro and P30 Pro
NOT COMPATIBLE WITH	<p>QUAD LOCK DESK MOUNT QUAD LOCK CAR MOUNT NOT SUITABLE FOR USE WITH UNIVERSAL ADAPTORS</p>
INCLUDED IN BOX	<p>1 x USB WEATHERPROOF WIRELESS CHARGING HEAD 1 x 50cm (20") USB-A TO USB-C CABLE WITH SEAL 1 x 1.5m (59") USB-A TO USB-C CABLE WITH SEAL 1 x 1.2m (47") USB-A TO RIGHT ANGLE USB-C CABLE WITH SEAL 1 x 3mm HEX KEY 1 x M5x35mm CSK HEAD HEX SOCKET SS316 SCREW - NATURAL w NYLOC 5 x 5mmx200mm NYLON ZIP TIES</p>
SPARE PARTS	<p>QLP-MWC-USB - MOTO WIRELESS CHARGER USB CABLES QLP-MWC-USB-RA - MOTO WIRELESS CHARGER USB CABLE - RIGHT ANGLE</p>
MATERIALS	<ul style="list-style-type: none"> • GLASS FILLED NYLON TOP CAP & TOP HOUSING • ANODISED ALUMINIUM REAR HOUSING • SS316 SCREW • TPE / PVC USB-A TO USB-C CABLE
MEASUREMENTS	80mm L x 67mm W x 27.6mm H

PRODUCT DETAILS	INDIVIDUAL	INNER CARTON	MASTER CARTON
QTY	-	5 Units	20 Units
SKU CODE	QLA-MOT-WCH-3	5QLA-MOT-WCH-3	20QLA-MOT-WCH-3
BARCODE	9348943017572	19348943017579	29348943017576
DIMENSIONS (L x W x H)	17.5cm x 3.3cm x 11.0cm	19.0cm x 12.3cm x 19.2cm	52.0cm x 22.5cm x 23.5cm
WEIGHT	0.232 kg	1.48 kg	6.5 kg

LED STATUS

	POWER ON
	ERROR MODE
	CHARGING
	LOW INPUT POWER MODE <5W (5V/1A)
	FULL CHARGE
	WIRELESS CHARGER OVER HEATING

The phone may reach 100% charge but in some instances it may take a long time for the cyan light to show.

WIRING OPTIONS

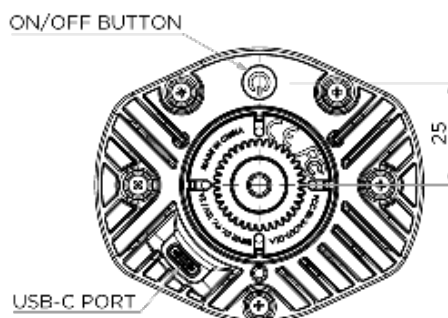
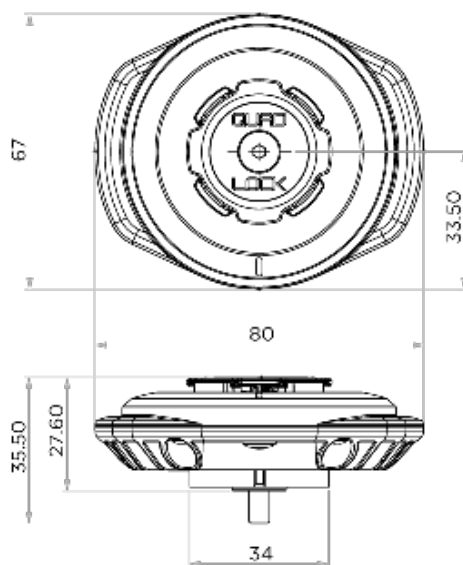
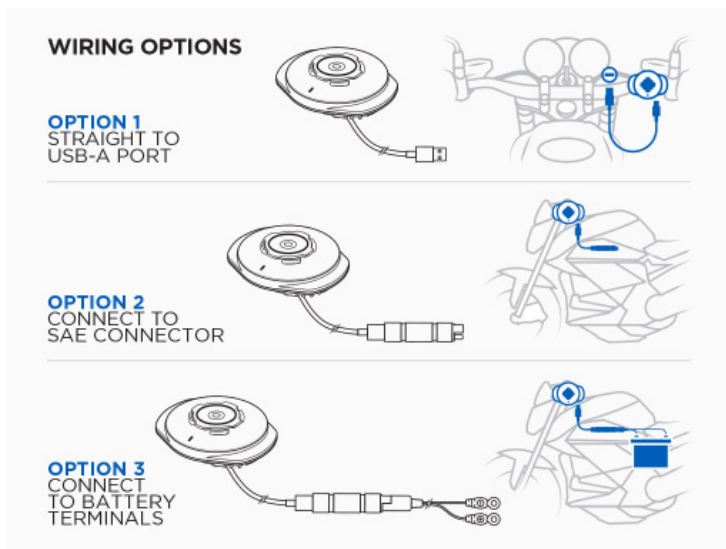

All dimensions in mm

DESIGNED IN
AUSTRALIA

PATENTED. &/OR
PAT. PEND. & TM:
QUADLOCKCASE.COM/IP

©2022 QUAD LOCK Pty Ltd
Designed in Melbourne, AUS | Made in China | All Rights Reserved
All trademarks are property of their prospective owners

Head Office: Suite 6A, Level 3, The Como Centre,
299 Toorak Rd, South Yarra, VIC 3141, Australia

QUADLOCKCASE.NET