

# INSTALLATION INSTRUCTIONS

**1.**

Clean the surface thoroughly using rubbing alcohol (Isopropyl)



**2.**

Peel off the protective layer from the 3M™ VHB Adhesive

**3.**

Position your Adaptor centrally on the rear of your device or case

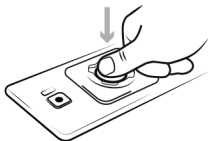
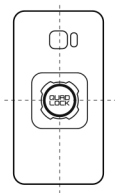

**4.**

Press down firmly to achieve a strong bond

**WARNING:** This product contains small magnets, which if they become loose and are swallowed may cause serious injury. Keep away from children or pets, and if ingested seek immediate medical attention. Do not use in close proximity to any sensitive or implanted medical device.